

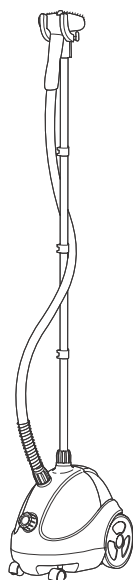

English

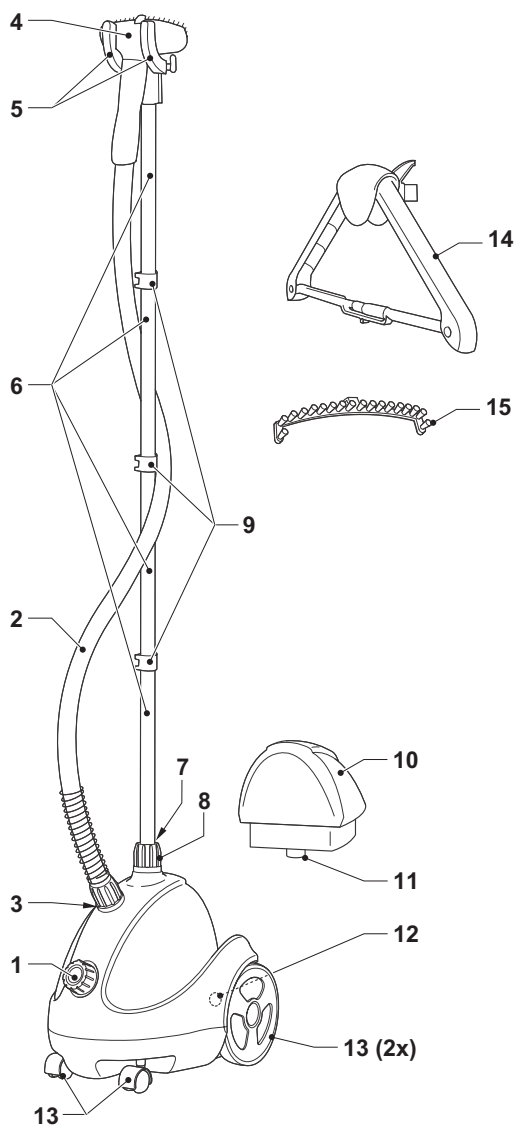



A1

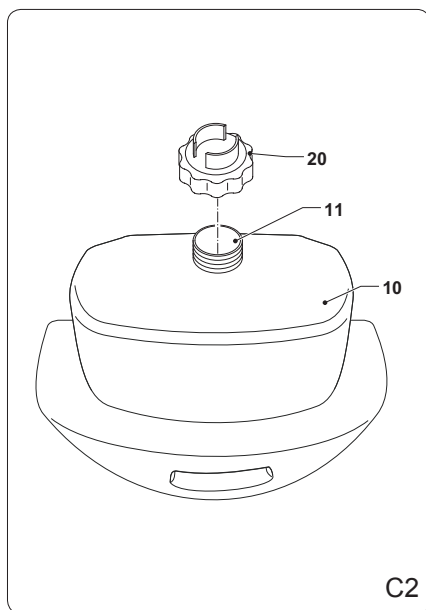
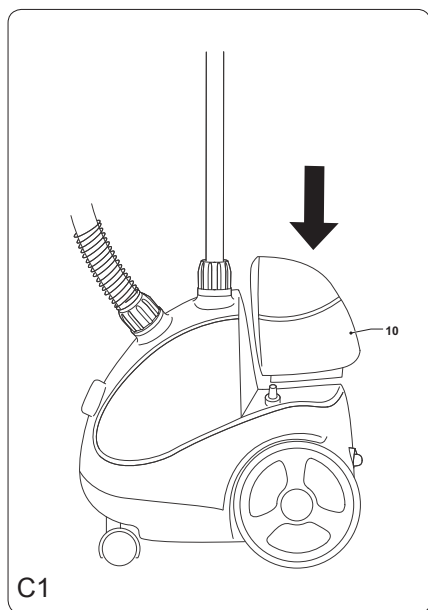
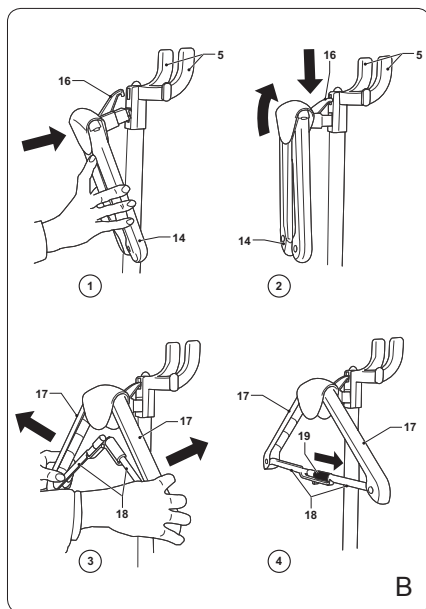
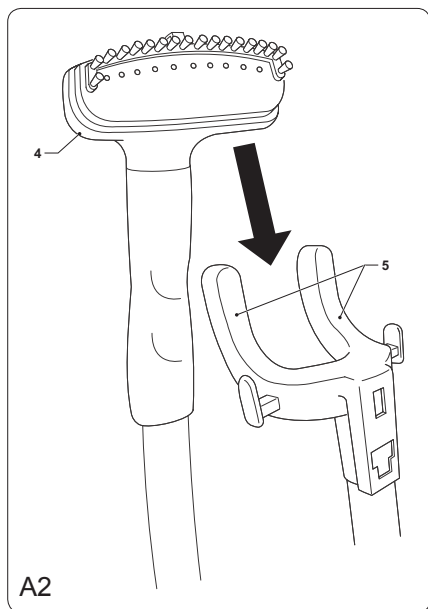

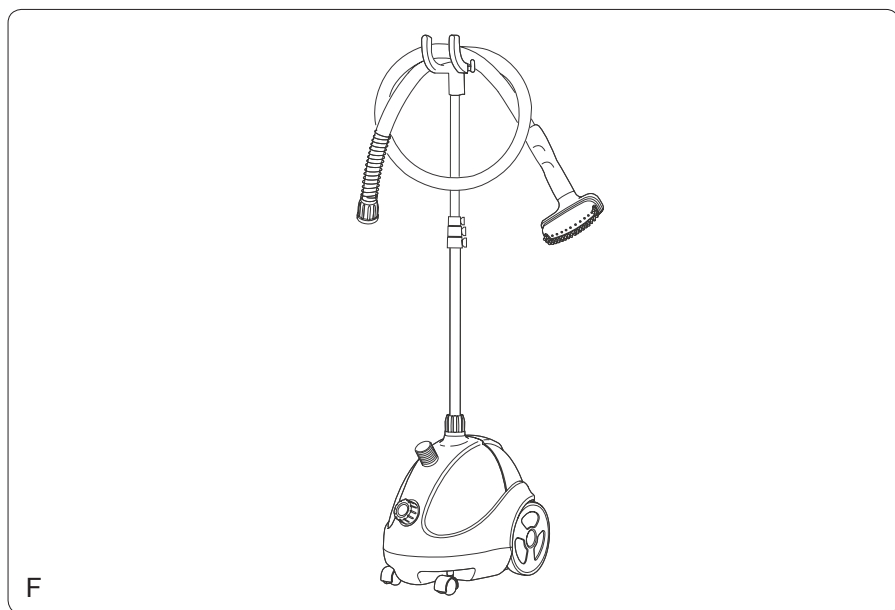
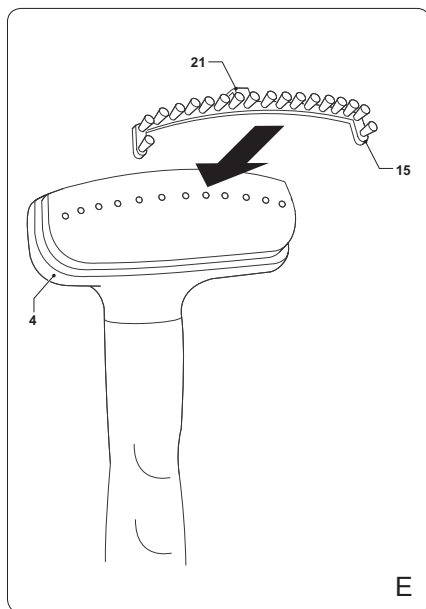
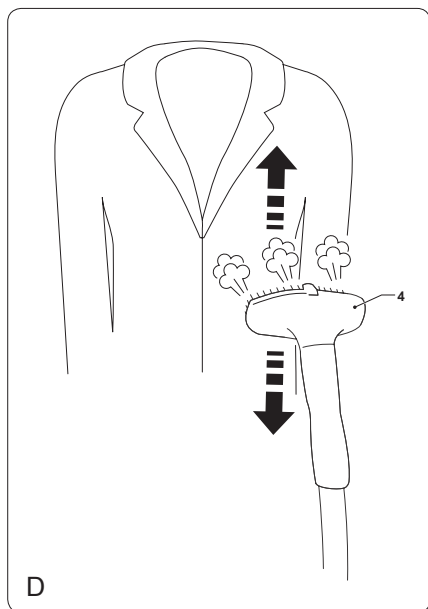

Congratulations!

You have purchased a Princess product. Our aim is to provide quality products with a tasteful design and at an affordable price. We hope that you will enjoy this product for many years.

Description (fig. A)

Your 332834 Princess garment steamer has been designed for steaming garments and fabrics to remove creases. The appliance is suitable for indoor use only. The appliance is suitable for domestic use only.

1. On/off switch / On/off indicator
2. Steam hose
3. Steam hose connection
4. Steam head
5. Steam head holder
6. Telescopic pole
7. Pole connection
8. Locking knob (telescopic pole)
9. Clamps (telescopic pole)
10. Water reservoir
11. Water filling point
12. Water drain point
13. Wheels
14. Clothes hanger
15. Fabric brush

Initial use

- Clean the appliance. Refer to the section "Cleaning and maintenance".

Assembly (fig. A)

Before you proceed, we need you to pay attention to the following notes:

- Before assembly, switch off the appliance and remove the mains plug from the wall socket.
- Make sure that the telescopic pole is fully extended to provide a free flow of steam.
- Place the water reservoir (10) into the appliance.
- Insert the telescopic pole (6) into the pole connection (7). Turn the locking knob (8) clockwise to lock the telescopic pole (6).
- Release the clamps (9). Set the telescopic pole (6) to the maximum height. Lock the clamps (9).

- Mount the steam head holder (5) to the telescopic pole (6).
- Tighten the steam hose (2) onto the steam hose connection (3).
- Hang the steam head (4) onto the steam head holder (5).

Assembling the clothes hanger (fig. B)

- Hold the clothes hanger (14) as shown and insert it into the steam head holder (5). Press the hook (16) into the steam head holder (5).
- Pull the arms (17) outwards until the poles (18) are in line with each other.
- Push the fixed pipe (19) onto the pole (18) until it locks into place.

Use

Filling the water reservoir (fig. C)

Before you proceed, we need you to pay attention to the following notes:

- Before filling the water reservoir, switch off the appliance and remove the mains plug from the wall socket.

Before you proceed, we would like you to focus your attention on the following notes:

- Do not use the appliance without water in the water reservoir.
- It is recommended to fill the water reservoir with a mixture of 50% tap water and 50% distilled water in order to prevent the formation of excessive limescale.
- Only use cold water to fill the water reservoir.
- Do not use carbonated water or other liquids to fill the water reservoir.

- Remove the water reservoir (10) from the appliance.
- Remove the cap (20).
- Fill the water reservoir (10) through the water filling point (11) with the required amount of water.
- Mount the cap (20).
- Place the water reservoir (10) into the appliance.

Hints for use (fig. A - D)

- Place the appliance on a stable, flat and heat-resistant floor.
- Remove the water reservoir (10) from the appliance. Fill the water reservoir (10) with the required amount of water. Place the water reservoir (10) into the appliance.
- Hang the steam head (4) onto the steam head holder (5).
- Insert the mains plug into the wall socket.
- To switch on the appliance, turn the on/off switch (1) clockwise. The on/off indicator (1) comes on. The appliance starts heating.

Note: Keep the steam head (4) on the steam head holder (5) during the heat-up process.

- Wait for approximately 45 seconds until the steam head (4) starts emitting steam. The appliance is ready for use.
- Remove the steam head (4) from the steam head holder (5) with the steam vents pointing away from you.
- Hang the garment on the clothes hanger (14).
- Hold the steam head (4) with the steam vents pointing away from you.
- Lightly touch the garment with the steam head (4). Move the steam head (4) in a vertical direction, starting at the top of the garment and gradually moving downwards (fig. D).

Note: The appliance may make a gurgling sound during use, which is a normal result of condensation. If a gurgling sound occurs, hold the steam hose (2) in an upright position to drain the excess moisture back into the water reservoir.

- If necessary, add more water into the water reservoir (10).
- If the process is completed, remove the garment from the clothes hanger (14) and hang the steam head (4) on the steam head holder (5).
- To switch off the appliance, turn the on/off switch (1) counterclockwise. The on/off indicator (1) goes off. The steam head (4) stops emitting steam.
- Remove the mains plug from the wall socket.

- Allow the appliance to cool down completely.

Accessories (fig. A & E)

Fabric brush (fig. E)

The fabric brush (15) is used to open the weave of the fabric for better steam penetration.

Before you proceed, we need you to pay attention to the following notes:

- Before mounting the accessory, switch off the appliance, remove the mains plug from the wall socket and wait until the appliance has cooled down.
- Mount the fabric brush (15) to the steam head (4) by aligning the bottom of the fabric brush with the bottom of the steam head. Gently push the top of the fabric brush (15) on the steam head (4) until it clicks into place.
- Gently brush the area to be steamed with the grain or nap of the fabric.
- Move the steam head (4) in a vertical direction, starting at the top of the garment and gradually moving downwards.
- Remove the fabric brush (15) from the steam head (4) by pressing the tab (21) and pulling the fabric brush (15) forward.

Cleaning and maintenance

Before you proceed, we need you to pay attention to the following notes:

- Before cleaning or maintenance, remove the mains plug from the wall socket and wait until the appliance has cooled down.
- Do not immerse the appliance in water or any other liquids.

Before you proceed, we would like you to focus your attention on the following notes:

- Do not use aggressive or abrasive cleaning agents to clean the appliance.
- Do not use sharp objects to clean the appliance.
- Regularly check the appliance for possible damage.
- Regularly check the water reservoir for possible leakage.

- Clean the appliance after each use:
 - Hold the steam hose in a vertical position so that any condensation can flow back into the water reservoir.
 - Remove the steam hose.
 - Empty the water reservoir by draining the water through the water drain point into a sink.
 - Mount the steam hose.
 - Remove limescale and other contaminants from the steam head with a damp cloth and a non-abrasive cleaning agent.
 - Clean the housing with a soft, damp cloth.
- Store the appliance as shown (fig. F) in a dry and frost-free place, out of the reach of children.
- Let the appliance run for 10 minutes without steaming garments.
- To switch off the appliance, turn the on/off switch (1) counterclockwise. The on/off indicator (1) goes off.
- Remove the mains plug from the wall socket.
- Allow the appliance to cool down completely.
- Empty the water reservoir (10) by draining the descaling agent through the water drain point (12) into a sink.
- Thoroughly rinse the appliance with clean water.
- Thoroughly dry the appliance with a clean, dry cloth.

Safety instructions

General safety

Descaling the appliance (fig. A)

The appliance must be descaled regularly. If the appliance must be descaled, use a suitable descaling agent. Special descaling agents are available from our service station.

Note: Princess will not be responsible for any damage caused by descaling agents. Damage caused by not regularly descaling the appliance is not covered by the guarantee.

Before you proceed, we need you to pay attention to the following notes:

- Before descaling the appliance, remove the mains plug from the wall socket and wait until the appliance has cooled down.
- Do not immerse the appliance in water or any other liquids.

Before you proceed, we would like you to focus your attention on the following notes:

- Be careful when descaling the appliance to prevent damage to furniture or clothing.
- Do not use citric acid to descale the appliance.
- Fill the water reservoir (10) with a suitable descaling agent.
- Insert the mains plug into the wall socket.
- To switch on the appliance, turn the on/off switch (1) clockwise. The on/off indicator (1) comes on. The appliance starts heating.

- Read the manual carefully before use. Keep the manual for future reference.
- Only use the appliance and the accessories for their intended purposes. Do not use the appliance and the accessories for other purposes than described in the manual.
- Do not use the appliance if any part or any accessory is damaged or defective. If a part or an accessory is damaged or defective, it must be replaced by the manufacturer or an authorised repair agent.
- Children should be supervised to ensure that they do not play with the appliance.
- The use of this appliance by children or persons with a physical, sensory, mental or motorial disability, or lack of experience and knowledge can give cause to hazards. Persons responsible for their safety should give explicit instructions or supervise the use of the appliance.
- Do not use the appliance near bathtubs, showers, basins or other vessels containing water.
- Do not immerse the appliance in water or other liquids. If the appliance is immersed in water or other liquids, do not remove the appliance with your hands. Immediately remove the mains plug from the wall socket. If the appliance is immersed in water or other liquids, do not use the appliance again.

- This appliance is intended to be used in domestic and similar applications such as staff kitchen areas in shops, offices and other working environments; farm houses; by clients in hotels, motels and other residential type environments; bed-and-breakfast type environments.

Electrical safety

- Before use, always check that the mains voltage is the same as the voltage on the rating plate of the appliance.
- The appliance is not intended to be operated by means of an external timer or separate remote-control system.
- Connect the appliance to an earthed wall socket. If necessary, use an earthed extension cable of a suitable diameter (at least 3 x 1 mm²).
- For additional protection, install a residual current device (RCD) with a rated residual operating current that does not exceed 30 mA.
- Make sure that water cannot enter the contact plugs of the mains cable and the extension cable.
- Always fully unwind the mains cable and the extension cable.
- Make sure that the mains cable does not hang over the edge of a worktop and cannot be caught accidentally or tripped over.
- Keep the mains cable away from heat, oil and sharp edges.
- Do not use the appliance if the mains cable or the mains plug is damaged or defective. If the mains cable or the mains plug is damaged or defective, it must be replaced by the manufacturer or an authorised repair agent.
- Do not pull the mains cable to disconnect the mains plug from the mains.
- Disconnect the mains plug from the mains when the appliance is not in use, before assembly or disassembly and before cleaning and maintenance.

Safety instructions for garment steamers

- Do not use the appliance outdoors.
- Do not carry the appliance during use. The appliance is only intended for stationary use.

- Only move the steam head in a vertical direction, starting at the top of the garment and gradually moving downwards. Do not move the steam head in a horizontal direction. Do not move the steam head backward.
- Always hang the appliance using the steam head. Do not hang the appliance using the steam hose.
- Do not point the steam head at yourself or other persons during use.
- Do not steam garments while you or another person are wearing them.
- Be careful with hot steam to avoid burns.
- The accessible surfaces of the appliance can become very hot during use. Do not touch the accessible surfaces. Only touch the handgrips when the accessible surfaces are hot.
- Do not touch the steam head. The steam head becomes very hot during use.
- Make sure that your hands are dry before touching the appliance.
- Do not pull the steam hose to move the appliance. Always hold the telescopic pole to move the appliance.
- Switch off the appliance and let the appliance cool down before leaving it unattended and before replacing, cleaning or inspecting any parts of the appliance.

U.K. Wiring instructions

The wires in the mains lead are coloured in accordance with the following code:

BLUE	NEUTRAL
BROWN	LIVE
GREEN/YELLOW	EARTH

As the colours of the wire in the mains lead of this appliance may not correspond with the colour markings identifying the terminals on your plug, proceed as follows:

The wire which is coloured BLUE must be connected to the terminal which is marked with the letter N or coloured black.

The wire which is coloured BROWN must be connected to the terminal which is marked with the letter L or coloured red.

The wire which is coloured GREEN/YELLOW must be connected to the terminal which is marked with the letter E or (⏏) and is coloured GREEN or GREEN/YELLOW.

If a 13Amp (BS1363) plug is used, a 13Amp (BS1362) fuse must be fitted, or if any other type of plug is used, a 13Amp fuse must be fitted, either in the plug or adaptor, or on the distribution board.

Warning! This appliance must be earthed.

Disclaimer

Subject to change; specifications can be changed without further notice.

