



EN Instruction manual

CN 說明書



Pepper And Salt Mill Set
01.493000.16.001

PARTS DESCRIPTION / 零部件說明

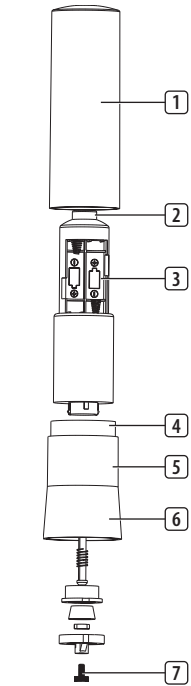

EN Instruction manual

SAFETY

- The manufacturer cannot be held responsible for damages resulting from a failure to comply to the safety instructions.
- This appliance is only meant to be used for household purposes
- This appliance shall not be used by children from 0 year to 8 years. This appliance can be used by children aged from 8 years and above if they are continuously supervised. This appliance can be used by people with reduced physical, sensory or mental capabilities or lack of experience and knowledge if they have been given supervision or instruction concerning use of the appliance in a safe way and understand the hazards involved. Children shall not play with the appliance. Keep the appliance out of reach of children aged less than 8 years. Cleaning and user maintenance shall not be made by children unless older than 8 and supervised.
- Do not expose the battery to high temperatures or direct sunlight. Never throw batteries into the fire. There is a danger of explosion!
- Keep batteries away from children. Batteries are not a toy!
- Do not open the batteries by force.
- Avoid contact with metallic objects.(Rings, nails, screws et cetera) there is a danger of short-circuiting!
- As a result of a short-circuit batteries may heat up consider-ably or even catch fire. this may result in burns.
- For your safety the battery poles should be covered with adhesive strips during transport.
- Do not touch a ruptured and/or leaking battery. If the liquid from the battery gets into your eyes, rinse your eyes as soon as possible with clean water, without rubbing your eyes. Immediately go to the hospital. If it is not treated properly, it can cause eye problems.

PARTS DESCRIPTION

1. Upper case
2. Power switch
3. Battery unit
4. Opening
5. Lower case
6. Viewing window
7. Adjustment wheel

BEFORE THE FIRST USE

- To install the batteries, please remove the upper cap by turning it counter-clockwise and lifting it upwards.
- Lift off the power unit and install 4 "AA" batteries into the battery compartment. Please ensure the + and - are aligned.
- Heavy duty batteries are recommended.

USE

- Fill the base compartment of the pepper mill with pepper or salt, using the opening on the base section.
- Attach the battery compartment back onto the lower case (make sure the small copper contacts will connect). Reconnect the upper case to the lower case in clockwise direction to lock the mill. The mill is now ready and safe to use.
- Press the power button on the top to start grinding.
- The mill is provided with a practical light at the bottom of the mill.
- For coarser grind, loosen the adjustment wheel at the bottom of the mill in anti-clockwise direction
- For finer grind, tighten the adjustment wheel at the bottom of the mill in clockwise direction

CLEANING AND MAINTENANCE

- To avoid corrosion after filling with salt, always wipe around the opening of the lower case ensuring the two copper contacts are free from salt or pepper.
- Do not leave empty batteries in the mill.
- Replace all 4 batteries at the same time, avoid mixing old batteries with new ones.
- Wipe the mill clean with a dry cloth.
- Do not place the mill in the dishwasher and do not immerse in water.
- Make sure the battery contacts don't get wet.
- Store the device in a dry environment.

GUARANTEE

- This product is guaranteed for 24 months granted. Your warranty is valid if the product is used in accordance to the instructions and for the purpose for which it was created. In addition, the original purchase (invoice, sales slip or receipt) is to be submitted with the date of purchase, the name of the retailer and the item number of the product.

ENVIRONMENT

- This appliance should not be put into the domestic garbage at the end of its durability, but must be offered at a central point for the recycling of electric and electronic domestic appliances. This symbol on the appliance, instruction manual and packaging puts your attention to this important issue. The materials used in this appliance can be recycled. By recycling of used domestic appliances you contribute an important push to the protection of our environment. Ask your local authorities for information regarding the point of recollection.

ZH-CHT 說明手冊

安全

- 若使用者未遵守安全指示而造成損傷，製造商概不承擔相關責任。
- 本設備僅供家用
- 請勿讓 0 歲至 8 歲的兒童使用此設備。8 歲以上的兒童可在持續受到監督的情況下使用此設備。生理、感官或心智不健全之人，或缺乏經驗知識之人，須有人在旁監督，或已指示如何安全使用本電器，且瞭解涉及的危險後，才可使用電器。

- 兒童不可玩耍電器。請勿將本設備放置於 8 歲以下兒童可觸及之處。8 歲以上的兒童且有大人在旁監督，才可進行清潔與保養工作。
- 切勿將電池置於高溫或陽光直射之處。切勿將電池丟入火中。電池可能會爆炸！
- 謹防電池被孩童拿到。電池並非玩具！
- 切勿用蠻力打開電池。
- 請勿接觸金屬物品（戒指、釘子、螺絲等），以免發生短路危險！
- 電池短路時，可能急劇升溫或著火，以致燙傷。
- 為安全起見，電池運送中應將正負極用膠帶蓋住。
- 請勿碰觸破裂與 / 或滲漏的電池。若電池中的液體不慎進入眼睛，應盡快以清水沖洗眼睛，並且避免揉眼。立即就醫。若未妥善治療，可能導致眼部問題。

零件說明

1. 容器上半部
2. 電源開關
3. 電池
4. 開口
5. 容器下半部
6. 觀察窗
7. 調節鈕

首次使用前

- 於安裝電池時，請以逆時針方向旋轉並上拉，以移除上蓋。
- 拿起電源組件，並在電池隔間中安裝 4 顆「AA」電池。請確定對準電池的正極與負極。
- 建議使用碳鋅電池。

使用

- 利用胡椒研磨器的底部開口，將胡椒或鹽填滿底部隔間。
- 將電池隔間裝回容器下半部（請確定小型銅接點妥善銜接）。將容器上半部以順時針方向再次和容器下半部連接，鎖住研磨器。現在可以安全地使用研磨器。
- 按下頂部的電源按鈕，即可開始研磨。
- 研磨器底部設有實用燈源。
- 若希望研磨顆粒較大，請以逆時針方向鬆開研磨器底部的調節鈕。
- 若希望研磨顆粒較細緻，請以順時針方向旋緊研磨器底部的調節鈕。

清潔與保養

- 為了避免於裝填後產生腐蝕情形，請務必擦拭容器下半部的開口周圍，以確保兩個銅接點沒有殘留的鹽或胡椒。
- 請勿將電力耗盡的電池留置在研磨器中。
- 請同時放置 4 顆新電池，避免新舊電池混用。
- 請以乾布擦拭以保持研磨器清潔。
- 請勿將研磨器置於洗碗水中，或浸泡於水中。
- 請確保電池連接點未受潮。
- 請將設備收納於乾燥環境中。

保證

- 本產品享有 24 個月保固。只要產品依據指示使用，且用於原本的製造用途，您的保固仍然有效。此外，原始購買證明（發票、銷貨單或收據）要附上購買日期、零售商名稱及產品項號提交。

環境

- 本電器不可在使用壽命結束時以家庭廢棄物處理，而是要棄置於回收電機電子家用電路的集中回收處。電器、使用手冊及包裝上的符號主要用於引起您對於重要議題的注意。本電器採用可回收的材質。您可回收二手家用电器，對環境保護盡一份心力。請向當地主管機關詢問相關的回收處資訊。