



**EN** Instruction manual

**NL** Gebruiksaanwijzing

**FR** Mode d'emploi

**DE** Bedienungsanleitung

**ES** Manual de usuario

**PT** Manual de utilizador

**IT** Manuale utente

**SV** Bruksanvisning

**PL** Instrukcja obsługi

**CS** Návod na použití

**SK** Návod na použitie

**DK** Brugervejledning

**FI** Ohjekirja

**NO** Bruksanvisningen



**Smart Dehumidifier**

01.368020.01.001

Diagram illustrating the components of the Princess 20000 BTU Dehumidifier:

- 1: Main unit
- 2: Water tank
- 3: Air filter
- 4: Front panel
- 5: Bottom panel
- 6: Control panel
- 7: Side panel

## SAFETY

- Please read this user's manual carefully to ensure proper use, maintenance and installation.
- By ignoring the safety instructions the manufacturer cannot be held responsible for the damage.
- The appliance is for indoor use only.
- Do not use the unit on a socket under repairs or not installed properly.
- Do not use the unit:
  - near a source of fire.
  - in an area where oil is likely to splash.
  - in an area exposed to direct sunlight.
  - in an area where water is likely to splash.
  - near a bath, a shower or a swimming pool.
- Never insert your fingers or any other object into the air outlet. Take special care to warn children of these dangers.
- Keep the unit upward while transport and storage.
- Before cleaning or moving the unit, always turn off or disconnect the power supply.
- If the supply cord is damaged, it must be replaced by the manufacturer, its service agent or similarly qualified persons in order to avoid a hazard.
- Never move the appliance by pulling the cord and make sure the cord cannot become entangled.
- The appliance must be placed on a stable, level surface.
- This appliance is only to be used for household purposes and only for the purpose it is made for.
- The appliance shall be installed in accordance with national wiring regulations.
- Notes:
  - Contact the dealer or a designated repair shop if any parts are damaged;
  - In case of any damage, please turn off the unit, disconnect the power supply and contact the dealer or a designated repair shop.
  - In any case, the power cord shall be firmly grounded.
  - This appliance shall not be used by children aged less than 8 years. This appliance can be used by children aged from 8 years and above and persons with reduced physical,

EN

sensory or mental capabilities or lack of experience and knowledge if they have been given supervision or instruction concerning use of the appliance in a safe way and understand the hazards involved. Children shall not play with the appliance. Keep the appliance and its cord out of reach of children aged less than 8 years. Cleaning and user maintenance shall not be made by children unless older than 8 and supervised.

**Warning**

- To protect yourself against an electric shock, do not immerse the cord, plug or appliance in the water or any other liquid.
  - The appliance shall be stored in a room without continuously operating ignition sources (for example: open flames , an operating gas appliance or an operating electric heater).
  - Do not pierce or burn.
  - Be aware that refrigerants may not contain an odor.
  - Contact authorized service technician for repair or maintenance of this unit.
- Do not pull , deform or modify the power supply cord , or immerse it in water . Pulling or misuse of the power supply cord can result in damage to the unit and cause electrical shock.
  - Compliance with national gas regulations shall be observed.
  - Keep ventilation openings clear of obstructions.
  - Any person who is involved with working on or opening a refrigerant circuit should hold a current valid certificate from an industry accredited assessment authority which authorizes their competence to handle refrigerants safely in accordance with an industry recognized assessment specification.
  - Servicing should only be performed as recommended by the equipment manufacturer. Maintenance and repair requiring the assistance of other skilled personnel should be carried out under the supervision of a person(s) competent in the use of flammable refrigerants.
  - Do not stop the unit by pulling out the power plug whilst in operation as this may cause an electric shock or fire due to heat generation

unless strange sounds are heard or if strange smells or smoke appear from the unit.

- Unplug the unit if strange sounds, smell, or smoke comes from it.



#### Caution

- Please make sure the product ventilates all the time, make sure the inlet and outlet ventilation are not blocked in any way.
- Operate this unit on a horizontal surface to avoid water leakage.
- Do not operate this unit in an explosive or corrosive atmosphere.
- Operate this unit in an ambient of 35 degree centigrade or less.
- When the unit is shut off, please wait at least 3.5 minutes before restarting. This to prevent the compressor from being damaged.

- To avoid the household electricity block out, please do not use any extension cord for this unit.

#### Refrigerant

Specific information regarding appliances with R 290 refrigerant gas.

- Thoroughly read all of the warnings.
- When defrosting and cleaning the appliance, do not use any tools other than those recommended by the manufacturing company.
- The appliance must be placed in an area without any continuously sources of ignition (for example: open flames, gas or electrical appliances in operation).
- Do not puncture and do not burn.
- This appliance contains Y g (see rating label back of unit) of R290 refrigerant gas.
- R290 is a refrigerant gas that complies with the European directives on the environment. Do not puncture any part of the refrigerant circuit.
- If the appliance is installed, operated or stored in a non-ventilated area, the room must be designed to prevent to the accumulation of refrigerant leaks that could

EN

result in a fire risk or explosion due to ignition of the refrigerant caused by electric heaters, stoves, or other sources of ignition.

- The appliance must be stored in such a way as to prevent mechanical failure.
- Individuals who operate or work on the refrigerant circuit must have the appropriate certification issued by an accredited organization that ensures competence in handling refrigerants according to a specific evaluation recognized by associations in the industry.
- Repairs must be performed based on the recommendation from the manufacturing company. Maintenance and repairs that require the assistance of other qualified personnel must be performed under the supervision of an individual specified in the use of flammable refrigerants.

(CE) N 842/2006: This unit contains the refrigerant R290. The amount of refrigerant is less than 1kg, and is in a closed cooling circuit. The coolant does have zero ozone depletion potential, but is a so-called greenhouse gases under the Kyoto Protocol and may thus contribute to global warming, if it is released to the atmosphere. Therefore only trained technicians with refrigerant certificate make a filling or emptying. Your appliance does not have be refilled with refrigerant if used properly and has an undamaged coolant circuit. GWP: R290: 3



- **WARNING:** In order to avoid overheating, do not cover the heater.

## PARTS DESCRIPTION

1. Supply cord
2. Tank
3. Filter
4. Back
5. Air outlet
6. Display
7. Front

## BEFORE THE FIRST USE

- Place the unit in the correct upright position before unpacking.
- Take the appliance and accessories out the box. Remove the stickers, protective foil or plastic from the device.
- Before using your appliance for the first time, wipe off all removable parts with a damp cloth. Never use abrasive products.
- Please ensure the unit is not placed against objects which will obstruct air intake e.g. furniture or curtains as this will affect its performance dramatically.
- Please don't place or operate the unit in a narrow place
- Do not place the unit in full sun as it might shut down due to overheat and the color of the unit may soon fade out.
- Do not place the unit in a humid place.

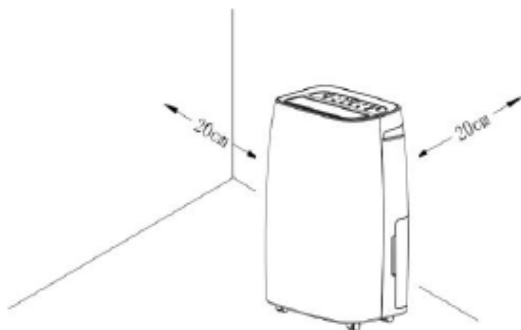

- A distance of 20cm minimum must be kept between the unit and the wall or any other obstacles.



- Put the power cable into the socket. (Note: Make sure the voltage which is indicated on the device matches the local voltage before connecting the device. Voltage 220V-240V 50Hz).

## FUNCTIONS OF CONTROL PANEL

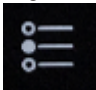
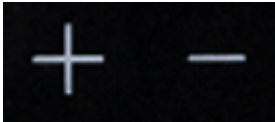

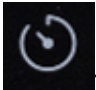
-  **Power button:** Press to turn ON/OFF the unit. When powered on the current humidity level will be shown. The unit will begin in "CO" (Continuous) mode as default.
-  **Mode:** use to switch between the different modes.
  - Dehumidify (Auto or Manual operation)
  - Fan (Fan mode only)
  - Laundry (Full power mode)
-  **Up-Down:** Set the required humidity: "CO" (continuous), 30 to 90% and "AU" (Automatic). The default mode is "CO". Note: Press up and down at the same time to convert the display from Humidity to Temperature. The display will go back to Humidity after 5 seconds.
-  **Speed:** Fan speed can be switched between high or low. Note: In comfortable mode ("AU") with a room temperature above 27 degree and in Laundry mode the fan speed is fixed and cannot be adjusted.
-  **Timer** (Regular time range 01-24 hours):

EN

- In the **power on state** press timer to set the timer for scheduled shutdown.
- In the **off state** press timer to set the timer for scheduled start of the dehumidifier.



- **Swing:** Swing function on/off, pressing the button when the dehumidifier is on will let the louver swing continuously, press the button again to let the louver stop moving. When stopped the Louver will be fully open to maximise airflow.



- **Child lock:** Hold for 5 seconds to activate the child lock function, all other functions will not work when activated, to disable the child lock hold the same button again for 5 seconds.



- **Wi-Fi:** To set the dehumidifier in pair mode, press and hold the Wi-Fi button until the indicator starts to flash, it could take about 6 seconds, then follow the steps in the Princess Home app.

## DEHUMIDIFY MODE SETTINGS

### Manual humidity set operation:

In this mode you can set a custom humidity level from 30 to 90%. The dehumidifier will work to reduce the humidity providing the room humidity level is above the set level.

Once the humidity is reduced the compressor will automatically turn off and the fan will continue to run. If the humidity level rises again then the compressor will begin again.

### CO (Continuous) operation:

In this mode the dehumidifier will continuously run regardless of the room humidity. The fan speed can be adjusted.

### AU (Automatic) operation:

In this mode the dehumidifier will operate automatically to the below levels:

Room temperature 5c to 20c = 60% humidity.  
Room temperature 20c to 27c = 55% humidity.  
Room temperature above 27c = 50% humidity.

### Laundry mode:

In this mode the dehumidifier is in full power operation and will continue to operate regardless of the humidity level. The fan speed is locked on high and cannot be adjusted.

### Fan mode:

In this mode the dehumidifier will only operate for air circulation and the compressor will not run. The humidity will not be reduced in this mode.



**Water full:**

If the water tank is full the full indicator will show red and an alarm will sound. Empty and replace the water tank and the dehumidifier will automatically resume its set operation.

NOTE: The compressor will not begin until 3 minutes has passed.

**Automatic Defrost:**

It is possible that the dehumidifier can produce internal frost. This is normal and the dehumidifier will automatically go into defrost mode when frost is detected to reduce this.

The compressor will turn off and the fan will continue, once the defrost has finished the compressor will start and normal operation will continue.

## USING THE DEHUMIDIFIER WITH PRINCESS HOME APP



- The dehumidifier can be used manually with its built-in controls or you can use a smart phone or smart speaker to control it. Before you begin, ensure the Princess Home app is downloaded. The Princess Home app is available on Android and iOS.
- Download the correct version of the Princess Home app via our website [princesshome.eu/nl-nl/princess-home-app](http://princesshome.eu/nl-nl/princess-home-app) or use QR:

**Pair your dehumidifier to Princess Home app**

- Make sure your dehumidifier is powered and that the unit is in pair mode by pressing and holding the Wi-Fi button, it could take about 6 seconds.
- Open the Princess Home app.

- Select your country code, enter the cell phone number and tap "Get" to get a message containing the verification code.
- Enter the verification code in the message and tap "Log in" to log in to the App.
- Click "Add Device" to add a new device.
- Select the device you wanted to connect.
- Follow the instructions on the app to connect the dehumidifier.
- To control your device with voice using a smart speaker please refer to the manufacturer's instructions on how to enable a skill through your device.

## EMPTY THE WATER TANK

- When the drainage tank is full, the tank full indicator light will turn on, the operation will stop automatically and the buzzer will beep 15 times.
- Gently press on the sides of the tank and pull the tank out with both hands.



- Empty the water tank above a sink.

- Do not remove the float from the water tank, otherwise the water sensor cannot detect the water level, causing the unit to malfunction.



- If the tank is dirty, use water for cleaning. Do not use gasoline or other chemicals, because it may damage the water tank and cause water leakage.
- Press the tank tightly with both hands to put it into place.
- If the water tank is not positioned correctly, the full water sensor will remain active and the dehumidifier will not work.

## CONTINUOUS WATER DRAINAGE

- The unit features a continuous drainage port. Using a plastic pipe (with an inner diameter of 10mm). Take out the water tank and put the drainpipe over the water outlet of the unit. Put the water tank back in place and guide the drainpipe through the hole of the water tank. The water in the drainage tank can be continuously drained out from the continuous port on the unit.

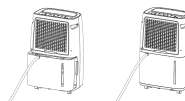

## FILTER CLEANING

- Take the filter out of the unit.

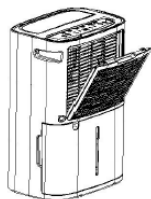

- Clean the filter using a vacuum cleaner to gently absorb dust on the filter screen surface.
- Use some warm water and a mild detergent if it is very dirty. Make sure the filter is completely dry before you put it back.

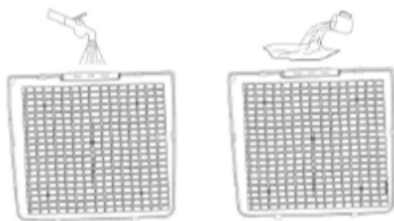

- Push the two hooks to put the filter back into the unit.

## CLEANING MAINTENANCE

- Before cleaning, be sure to disconnect the unit from any electric supply outlet.
- First clean the surface with a neutral detergent and wet cloth, and then wipe it with a dry cloth.
- Do not use gasoline or other chemicals to clean the unit.

## STORAGE

- Empty the water in the tank.
- Roll up the power cord.
- Clean the filter.
- Store the unit in a cool and dry place.

## TROUBLESHOOTING

Problem	Possible causes	Suggested solution
The machine doesn't work.	Is the power line properly connected?	Connect the plug into the socket.
	Full water indicator light is on (water tank full or not in the right place).	Drain the water in the tank and put it in place.
	The room temperature is above 35 degrees or under 5 degrees.	The protection is started and the machine will not work.
	Is the lock on?	If the lock is on, please unlock by press and hold the lock button for 5 seconds.

Dehumidification function cannot start.	Is the filter blocked?	Clean the filter (screen) according to the cleaning instructions.
	Is the air inlet or outlet blocked?	Remove the obstruction from the air inlet or outlet.
The machine makes noise.	Is the machine tilted?	Move the machine to a flat, horizontal surface.
	Is the filter blocked?	Clean the filter (screen) according to the cleaning instructions.
E1 Code	Coil sensor short circuit or open circuit	Check if the line is loose or replace the coil sensor.

## THE PRODUCT OR EQUIPMENT CONTAINS FLUORINATED GREENHOUSE GAS.

Art.nr. 368020

Coolant: R290

Quantity in kg: 0.05

Global Warming Potential: 3

CO2 Equivalent in tonnes: 0.00015

## DECLARATION OF CONFORMITY

- Hereby, Smartwares Europe declares that the radio equipment type 368020 is in compliance with Directive 2014/53/EU
- The full text of the EU declaration of conformity is available at the following internet address: [www.princesshome.eu/doc](http://www.princesshome.eu/doc)

## ENVIRONMENT



■ This appliance should not be put into the domestic garbage at the end of its durability, but must be offered at a central point for the recycling of electric and electronic domestic appliances. This symbol on the appliance, instruction manual and packaging puts your attention to this important issue. The materials used in this appliance can be recycled. By recycling of used domestic appliances you contribute an important push to the protection of our environment. Ask your local authorities for information regarding the point of recollection.

## Support

You can find all available information and spare parts at [www.princesshome.eu](http://www.princesshome.eu)!



Wireless technology: Wi-Fi  
Operating frequency: 2.400~2.484GHz  
Max. radio-frequency power: 17.5dBm

